

K Push tech concealed long

K Push tech long with buffer, grey

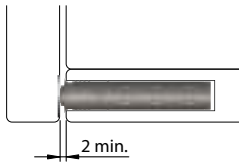

With magnet

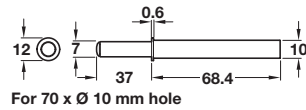
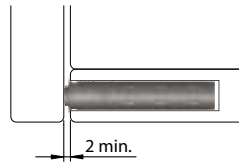

With buffer

- > Mechanism provides a silent yet powerful operation
- > Suitable for a wide range of doors
- > For installation in a Ø 10 mm hole or order surface mount fitting separately
- > Available either with magnet or with buffer
 - Order magnet version for cabinets using unsprung or negative hinges
 - Order buffer version for cabinets using sprung hinges
- > Grey, white or anthracite engineering plastic with magnet or rubber buffer
- > Order qty: 1 pc

K Push tech long surface mount fitting, white

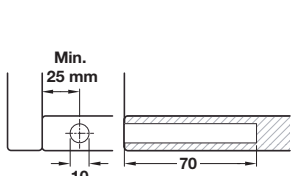
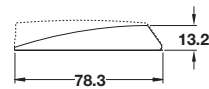
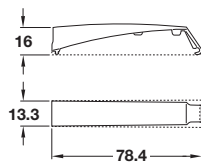

Recess mounted - long

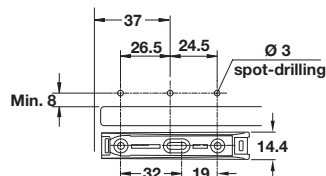

Surface mounted - long



Please do not press or release the spring until the K Push is fully installed



	Grey	White	Anthracite
With buffer	356.12.517	356.12.717	356.12.317
With magnet	356.12.505	356.12.705	356.12.305
Surface mount	356.12.595	356.12.795	356.12.395



Order surface mount fitting separately for surface mounting

Adhesive plate for magnet

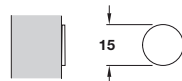

- > Self adhesive
- > Order qty: 1 pc

	Cat. No.
Adhesive plate for magnet	356.01.539

Plate for magnet

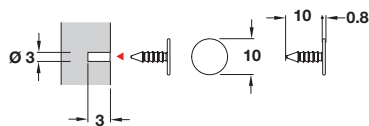

- > With Ø 3 mm pin
- > Order qty: 1 pc

	Cat. No.
Plate for magnet	356.01.549