

# K PUSH TECH CONCEALED

Concealed fixing. Push system for opening doors without handles.



Recess mounted



Surface mounted - order fittings separately

## K Push tech concealed short

### K Push tech short with magnet, anthracite

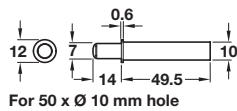

### K Push tech short surface mount fitting, anthracite

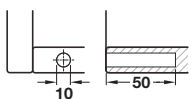
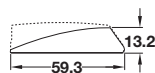
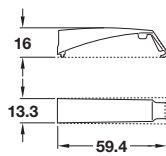

Recess mounted - short

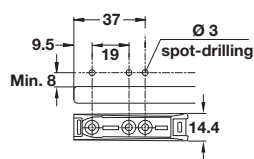

Surface mounted - short

- > Mechanism provides a silent yet powerful operation
- > Suitable for a wide range of doors
- > For installation in a Ø 10 mm hole or order surface mount fitting separately
- > Available either with magnet or with buffer
  - Order magnet version for cabinets using unsprung or negative hinges
  - Order buffer version for cabinets using sprung hinges
- > Grey, white or anthracite engineering plastic with magnet or rubber buffer
- > Order qty: 1 pc

**!** Please do not press or release the spring until the K Push is fully installed



**+** Order surface mount fitting separately for surface mounting

	Grey	White	Anthracite
With buffer	356.12.510	356.12.710	356.12.310
With magnet	356.12.500	356.12.700	356.12.300
Surface mount	356.12.590	356.12.790	356.12.390