

Legge - Latches

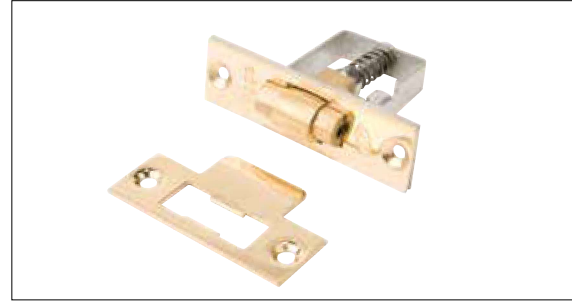

Tubular Latch - B3721, B3722 & B3724LK

- Mortice tubular latches
- Meets the requirements of EN 12209 (see table)
- CE marked (see table)
- 8mm high strength follower
- Available in electroplated brass or nickel plated finishes
- Lifetime guarantee

Roller Latch - B1511

- Mortice roller latch
- Brass roller latch
- Adjustable springing to provide a positive push/pull operation
- Available in polished brass or nickel plated finishes



Product Ref:	Function/description	Case size (a)	Backset (b)	Finishes	CE Classification
B3721	Tubular latch - CE marked	64mm	44mm	EB; NP; PB	NPD H810F-B010
B3722	Tubular latch - CE marked	76mm	57mm	EB; NP; PB	NPD H810F-B010
B3724LK	Tubular latch - lockable	95mm	76mm	EB; NP	N/A
B1511	Roller latch	51mm	N/A	PB; SS	N/A

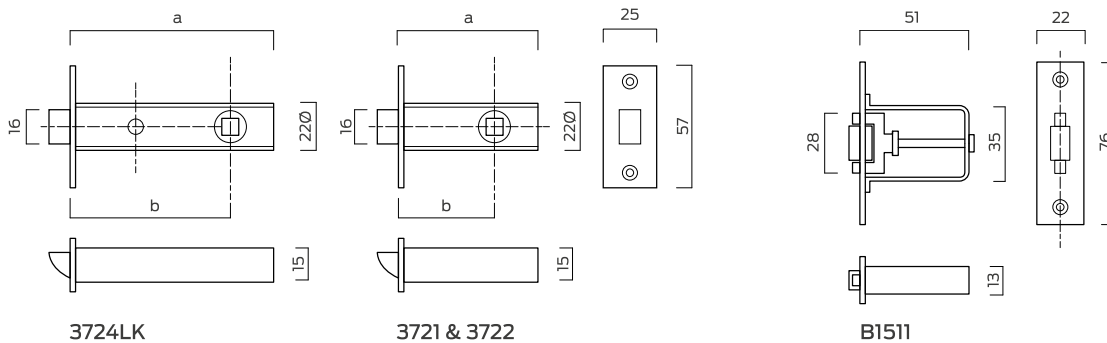

all dimensions are in mm